

KNOW ALL MEN BY THESE PRESENTS TO WIT:

THAT S-P-H CORPORATION IS THE FEE SIMPLE OWNER OF THE PROPERTY SHOWN HEREON AS A PORTION OF CITY OF SALEM TAX PARCEL 13-1-1, SAID PROPERTY HAVING BEEN CONVEYED TO SAID OWNERS BY DEED OF RECORD IN CLERK'S OFFICE OF THE CIRCUIT COURT OF THE CITY OF SALEM, VIRGINIA IN DEED BOOK 137 AT PAGE 54.

THE PLATTING OF LAND SHOWN HEREON HAS BEEN MADE WITH FREE CONSENT OF, AND IN ACCORDANCE WITH THE DESIRES OF THE UNDERSIGNED OWNERS, AS REQUIRED BY SECTIONS 15.1-465 THROUGH 15.1-485 OF THE CODE OF VIRGINIA, AND THE SUBDIVISION ORDINANCE OF THE CITY OF SALEM, VIRGINIA.

IN WITNESS WHEREOF ARE HEREBY PLACED THE SIGNATURES AND SEALS ON THIS 22 DAY OF JULY, 1997.

Benton C. Hopper 7-22-97
BENTON C. HOPPER DATE
S-P-H CORPORATION
V. Pres.
TITLE

NOTARY'S CERTIFICATE

STATE OF VIRGINIA AT LARGE

COUNTY/CITY OF SALEM

I, NANCY S. KIDD, A NOTARY PUBLIC IN AND FOR THE

AFORESAID CITY AND STATE, DO HEREBY CERTIFY THAT

BENTON C. HOPPER

PERSONALLY APPEARED BEFORE ME IN MY JURISDICTION AND ACKNOWLEDGED

THE SAME ON JULY 22, 1997.

MY COMMISSION EXPIRES ON SEPTEMBER 30, 2000.

Nancy S. Kidd
NOTARY PUBLIC

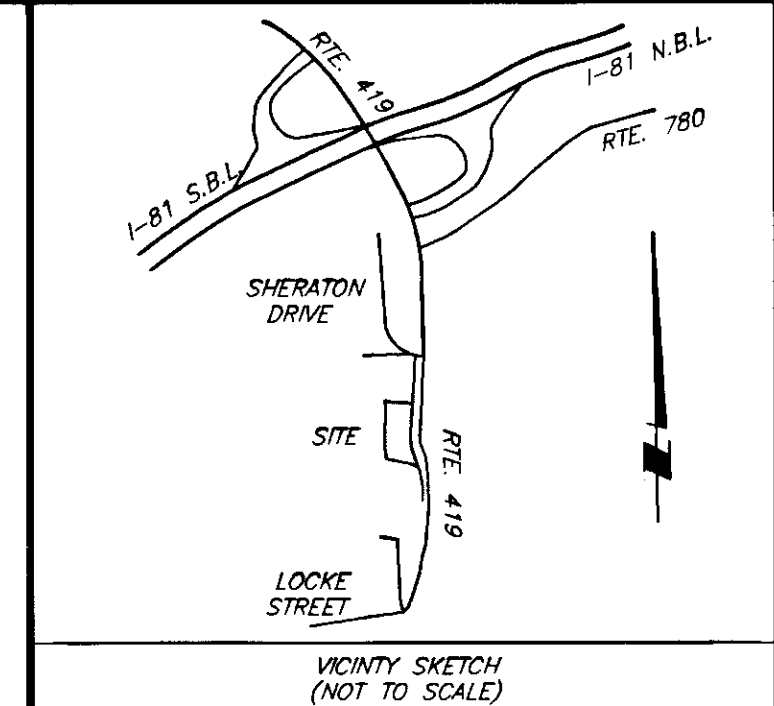
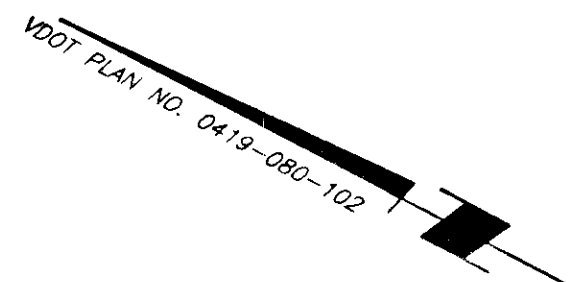

VIRGINIA PRIMARY ROUTE #419
(VARIABLE WIDTH R/W)

RUSSELL DRIVE
(VARIABLE WIDTH R/W)

LOT 5
4.000 AC.

REMAINING PORTION OF
TAX PARCEL 13-1-1
S-P-H CORPORATION
19.185 AC.

REMAINING PORTION OF
TAX PARCEL 13-1-1
S-P-H CORPORATION
19.185

AREA SUMMARY

AREA IN LOT 5	= 4.000 AC.
REMAINING PORTION OF TAX PARCEL 13-1-1	= 19.185 AC.

CURVE DATA

CURVE	RADIUS	LENGTH	TANGENT	CHORD	BEARING	DELTA
C-1	530.00'	211.29'	107.07'	209.89'	S 33°39'20" E	22°50'30"
C-2	920.00'	31.72'	15.86'	31.72'	S 44°05'19" E	01°58'31"

APPROVED: Forest G. Jones 7-25-97
FOREST G. JONES - EXECUTIVE SECRETARY, DATE
CITY OF SALEM PLANNING COMMISSION
John D. Abbott 7-25-97
JOHN D. ABBOTT, P.E. - CITY ENGINEER DATE

IN THE CLERK'S OFFICE OF THE CIRCUIT COURT OF THE CITY OF SALEM, VIRGINIA, THIS PLAT, WITH THE CERTIFICATE OF ACKNOWLEDGEMENT THERETO ANNEXED IS ADMITTED TO RECORD ON JULY 25, 1997, AT 1:02 O'CLOCK P. M.

TESTE: Chance Crawford CLERK
CHANCE CRAWFORD

Nanda M. Russell
DEPUTY CLERK

SURVEYOR'S CERTIFICATION

I hereby certify that to the best of my knowledge and belief this survey is correct and has been prepared based upon a current field survey and in accordance with the current standards of a boundary survey as established by the Virginia State Board of Architects, Professional Engineers, Land Surveyors and Landscape Architects.

Frederick O. Shanks, III
Land Surveyor #1544

6/25/97
Date

NOTES:

- THIS PLAT WAS PREPARED WITHOUT THE BENEFIT OF A TITLE REPORT AND THEREFORE MAY NOT INDICATE ALL ENCUMBRANCES UPON THE PROPERTY.
- THE SUBJECT PROPERTY IS NOT WITHIN A F.E.M.A. DEFINED FLOOD HAZARD ZONE AS OF 10/15/93 F.E.M.A. STUDIES. THE PROPERTY IS WITHIN ZONE "X" AS SHOWN ON F.E.M.A. COMMUNITY PANEL No. 51161C0023 D
- LOCATIONS SHOWN FOR ALL UNDERGROUND IMPROVEMENTS ARE APPROXIMATE ONLY AND ARE INTENDED EXPRESSLY FOR INFORMATIONAL PURPOSES.

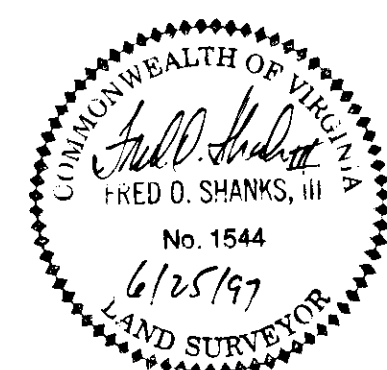

PLAT OF SUBDIVISION
FOR
S-P-H CORPORATION
OF A PORTION OF
TAX PARCEL 13-1-1
HEREBY CREATING
LOT 5
CITY OF SALEM, VIRGINIA

SHANKS ASSOCIATES, P.C.
SURVEYORS & PLANNERS
313 LUCK AVENUE
ROANOKE, VIRGINIA 24016
(540) 343-6685

DATE: 6/25/97	SCALE: 1"=100'
CALC: JRA	DRAWN BY: JRA
CREW: JRA	F.B.: 96.04
CHECKED BY: <u>[Signature]</u>	JOB NO.: 697018