

CURVE TABLE							
LOT	CURVE	LENGTH	RADIUS	TANGENT	CHORD	BEARING	DELTA
1	C1	22.48	879.14	11.24	22.48	N81°59'43"E	01°27'55"
1	C2	23.29	25.00	12.57	22.46	N54°34'16"E	53°22'59"
TOTAL	C3	271.26	55.00	44.08	68.79	S10°49'48"E	282°34'51"
1	C3	55.93	55.00	30.65	53.55	N57°00'41"E	58°15'48"
2	C3	71.84	55.00	42.08	66.84	S56°26'19"E	74°50'12"
3	C3	60.66	55.00	33.83	57.63	S12°34'37"W	63°11'40"
4	C3	82.83	55.00	51.55	75.22	S87°19'02"W	86°17'11"
4	C4	5.48	25.00	2.75	5.46	N55°48'50"W	12°32'55"

GENERAL NOTES:

- THIS PLAT WAS PREPARED WITHOUT BENEFIT OF A TITLE REPORT AND IS SUBJECT THERETO. THEREFORE, THERE MAY EXIST ENCUMBRANCES WHICH AFFECT THE PROPERTY NOT SHOWN HEREON.
- THE SUBJECT PROPERTY IS WITHIN THE LIMITS OF ZONE "X" AS SHOWN ON THE FEMA FLOOD INSURANCE RATE MAP NO. 51161C0043 D, EFFECTIVE DATE OCT. 15, 1993. THIS DETERMINATION IS BASED ON SAID MAP AND HAS NOT BEEN VERIFIED BY ACTUAL FIELD ELEVATIONS.

REFERENCE MAPS:

- SUBDIVISION OF SECTION ONE, HOMEPLACE SALEM BY T. P. PARKER & SON DATED SEPT. 28, 1994, REVISED FEB. 8, 1995 AND RECORDED IN P.B. 5, PG. 96.
- MAP SHOWING SECTION NO. 2 ORCHARD HEIGHTS BY C. B. MALCOLM & SON DATED AUG. 8, 1945 AND RECORDED IN P.B. 2, PG. 201 (ROANOKE CO).
- RESUBDIVISION FOR SALEM ENTERPRISES, L.L.C. BY T. P. PARKER & SON, DATED SEPTEMBER 14, 1999 AND RECORDED IN P.B. 7, PG. 85, SLIDE 156.

KNOW ALL MEN BY THESE PRESENTS TO WIT:  
 THAT SALEM ENTERPRISES, L.L.C., A VIRGINIA LIMITED LIABILITY COMPANY, IS THE FEE SIMPLE OWNER OF THE PROPERTY SHOWN HEREON CONTAINING A TOTAL OF 15.989 ACRES, BEING A PORTION OF THE PROPERTY CONVEYED TO SAID OWNER BY L. EARL SIMMS, A.K.A. EARL SIMMS BY DEED DATED AUGUST 11, 1994 AND RECORDED IN THE CLERK'S OFFICE OF THE CIRCUIT COURT OF THE CITY OF SALEM, VIRGINIA IN DEED BOOK 227, PAGE 315.  
 THAT SALEM ENTERPRISES, L.L.C., A VIRGINIA LIMITED LIABILITY COMPANY, IS ALSO THE FEE SIMPLE OWNER OF THE PROPERTY SHOWN HEREON CONTAINING A TOTAL OF 0.088 ACRE, BEING ALL OF THE PROPERTY CONVEYED TO SAID OWNER BY THE TRUSTEES OF L. EARL SIMMS REVOCABLE TRUST AGREEMENT DATED OCTOBER 5, 1999 AND RECORDED IN THE AFORESAID CLERK'S OFFICE IN DEED BOOK 317, PAGE 365.  
 THE SAID OWNER HEREBY CERTIFIES THAT IT HAS SUBDIVIDED THE LAND INTO LOTS AS SHOWN HEREON ENTIRELY OF ITS OWN FREE WILL AND ACCORD AS REQUIRED BY SECTION 15.2-2240 THROUGH 15.2-2276 OF THE 1950 CODE OF VIRGINIA AS AMENDED TO DATE AND THE CITY OF SALEM SUBDIVISION ORDINANCE AS AMENDED TO DATE AND VACATES LINES SHOWN DOTTED HEREON.  
 ALL EASEMENTS SHOWN HEREON ARE DEDICATED FOR PUBLIC USE. WITNESS THE SIGNATURE AND SEAL OF THE SAID OWNER.

*Mark Eric Simms*  
 MARK ERIC SIMMS, MANAGER DATE 12/15/99  
 SALEM ENTERPRISES, L.L.C., OWNER  
 D.B. 227, PG. 315, D.B. 317, PG. 365

STATE OF VIRGINIA  
 City of Salem  
 TO WIT:  
 I, John T. Parker Sr A NOTARY PUBLIC IN AND FOR THE AFORESAID STATE DO HEREBY CERTIFY THAT MARK ERIC SIMMS, MANAGER FOR SALEM ENTERPRISES, L.L.C., WHOSE NAME IS SIGNED TO THE FOREGOING WRITING HAS PERSONALLY APPEARED BEFORE ME AND ACKNOWLEDGED THE SAME IN MY AFORESAID JURISDICTION ON THIS 14<sup>TH</sup> DAY OF DECEMBER 1999.  
 MY COMMISSION EXPIRES: Oct 31, 2001  
*John T. Parker Sr*  
 NOTARY PUBLIC

IN THE CLERK'S OFFICE OF THE CIRCUIT COURT OF THE CITY OF SALEM, VIRGINIA THIS MAP WAS PRESENTED AND ADMITTED TO RECORD AT 11:30 O'CLOCK A. M. ON THIS 15<sup>TH</sup> DAY OF DECEMBER 1999.

TESTE:  
*Chance Crawford*  
 CHANCE CRAWFORD, CLERK  
 BY: *John T. Parker Sr*  
 DEPUTY CLERK

**JAMES A. & ELMA B. TRAMMELL SUBDIVISION**

LOT 2  
 PROPERTY OF  
**JACK W. & BARBARA W. COCHRAN**  
 TAX NO. 262-04-02.2  
 D.B. 127, PG. 97

LOT 1  
 PROPERTY OF  
**DIANE B. WING**  
 TAX NO. 262-04-02.3  
 D.B. 306, PG. 610

LOT 5  
**0.354 ACRE**  
 15,454 SQ FT

LOT 6  
**0.341 ACRE**  
 14,882 SQ FT

LOT 7  
**0.299 ACRE**  
 13,030 SQ FT

LOT 8  
**0.262 ACRE**  
 11,449 SQ FT

LOT 9  
**0.232 ACRE**  
 10,107 SQ FT

LOT 10  
**0.232 ACRE**  
 10,107 SQ FT

LOT 11  
**0.232 ACRE**  
 10,107 SQ FT

0.088 ACRE  
 TAX # 273-01-01  
 D.B. 317, PG. 365

LEGEND  
 M.B.L.=MINIMUM BUILDING LINE  
 P.U.E.=PUBLIC UTILITY EASEMENT  
 R/W=RIGHT OF WAY  
 U.E.=UTILITY EASEMENT  
 ☉=UTILITY POLE

LOT 14, BLK 3, SEC 2  
 ORCHARD HEIGHTS  
 PROPERTY OF  
**JOHN O. & MARY M. BUTLER**  
 TAX NO. 262-04-01  
 EXIST. 15' SANITARY SEWER EASEMENT

NEW LOT 4B  
 PROPERTY OF  
**JOSEPH & NANCY JEAN WITKOWSKI**  
 TAX NO. 262-04-02.4  
 D.B. 291, PG. 510

LOT 3  
 PROPERTY OF  
**DENNIE P. & SHERRI B. DENISON**  
 TAX NO. 262-04-02.1  
 D.B. 162, PG. 391

LOT 4  
**0.645 ACRE**  
 28,138 SQ FT

LOT 3  
**1.315 ACRE**  
 57,282 SQ FT

LOT 2  
**0.560 ACRE**  
 28,138 SQ FT

LOT 1  
**0.459 ACRE**  
 19,997 SQ FT

LOT C-1, 11.605 AC.  
 REMAINING PROPERTY OF  
**SALEM ENTERPRISES, L.L.C.**  
 TAX NO. 261-002-016  
 D.B. 227, PG. 315

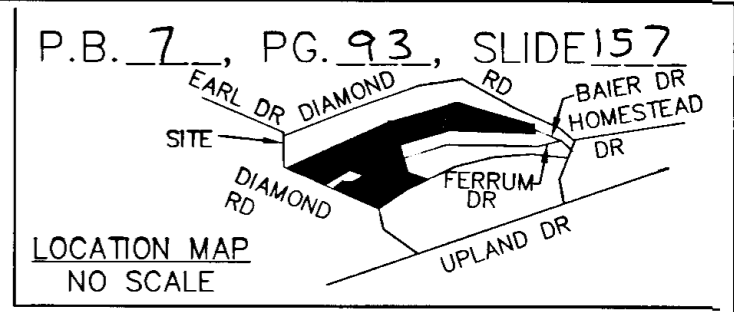

15.989 AC. LOT C  
 +0.088 AC. SIMMS TRACT  
 16.077 AC. TOTAL  
 -4.472 AC. LOTS 1=11  
 11.605 AC. LOT C-1

SECTION 1  
**HOMEPLACE SALEM**  
 P.B. 5, PG. 95

MAP OF  
**SECTION TWO HOMEPLACE SALEM**

SHOWING RESUBDIVISION OF LOT C, 15.989 ACRE TRACT SALEM ENTERPRISES, L.L.C. MAP P.B. 7, PG. 85, SLIDE 156 AND 0.088 ACRE TRACT SITUATE ON DIAMOND ROAD SALEM, VIRGINIA

TAX # 261-02-16 SCALE: 1" = 60'  
 TAX # 273-01-01 DATE: SEPTEMBER 30, 1999  
 DRAWN: DAP-Z/LRD/3 W.O. 99-0891  
 CALC: DAP/LRD N.B. SIMMS EST. #2

THIS SUBDIVISION IS BASED ON A CURRENT FIELD SURVEY. SALEM ENTERPRISES, L.L.C. IS THE OWNER OF RECORD. SEE D.B. 227, PG. 315 AND D.B. 317, PG. 365.

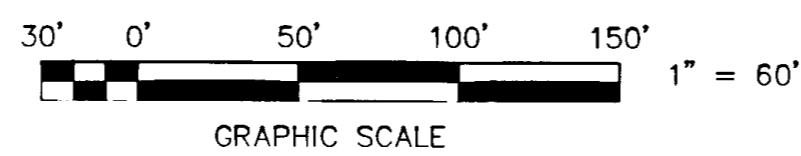
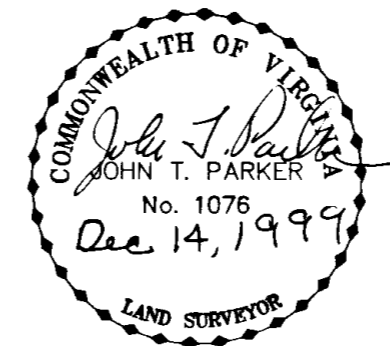

**TPP&S** T. P. PARKER & SON  
 ENGINEERS 816 Boulevard  
 SURVEYORS Post Office Box 39  
 PLANNERS Salem, Virginia 24153