

# GPS DATA SHEET

## Station Data

Station Name: <b>COSM 10-01</b>		Municipality: <b>City of Salem</b>	
Zone: <b>Virginia South-4502</b>	Convergence: <b>-0° 55' 28"</b>	Year Set: <b>2011</b>	
Projection: <b>Lambert</b>	Combined Factor: <b>0.99990078</b>	Year Recovered:	
<b>Horizontal Data</b>	Datum: <b>NAD 83</b>	Scale Factor: <b>0.999946413</b>	Order: <b>2nd</b>
	Northing: <b>3632866.063</b>		Easting: <b>11039816.980</b>
	Latitude: <b>37° 17' 25.44434" N</b>		Longitude: <b>80° 01' 23.72122" W</b>
<b>Vertical Data</b>	Elevation Factor: <b>0.999954365</b>	Order: <b>3rd</b>	
	Elevation: (NGVD 29) <b>1060.79</b>	Elevation: (NAVD 88) <b>1060.17</b>	

## Reference Station

Station	Grid Distance	Grid Azimuth
<b>COSM 10-02</b>	<b>3840.24'</b>	<b>260° 09' 03"</b>

## Station Location & Description

The station is located in the east side of the City of Salem, Virginia. To reach from the intersection of East Main Street (460) and Electric Road (Route 419), go south on Electric Road to intersection with Lynchburg Turnpike. Turn left on Lynchburg Turnpike. Go approx. 0.3 mile. The station is a brass disk, set in concrete on the north side of Lynchburg Turnpike, in front of a retention pond for the Salem Commons Apartment complex and is stamped COSM 10-01.

This survey data prepared using 1 meter= 3.2808333333 feet.

### Station Sketch

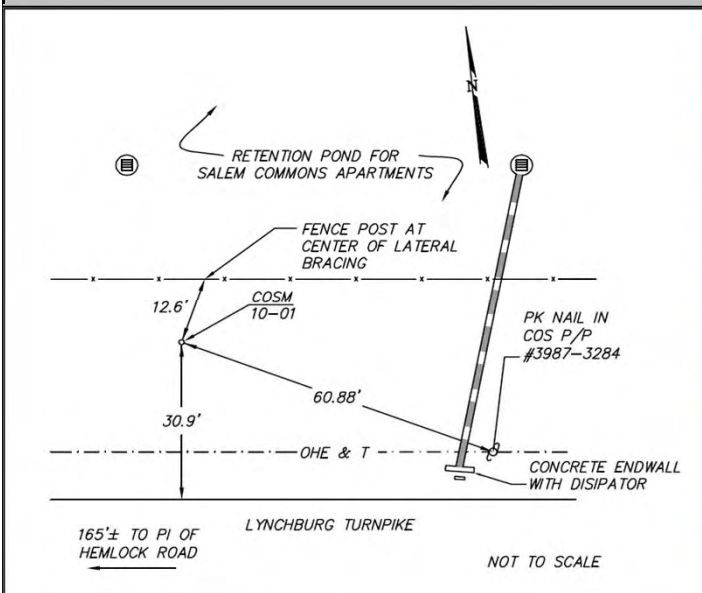

### Station Photograph



**CALDWELL WHITE ASSOCIATES**

ENGINEERS / SURVEYORS / PLANNERS

4203 Melrose Avenue, NW      Phone: (540)366-3400  
 P.O. Box 6260                      Fax: (540)366-8702  
 Roanoke, VA 24017                E-Mail: cwaroanoke@aol.com