

**Description**      **Station: COSM 0502**

**Location Sketch**

Station is a 4" bronze disk set in a concrete monument.

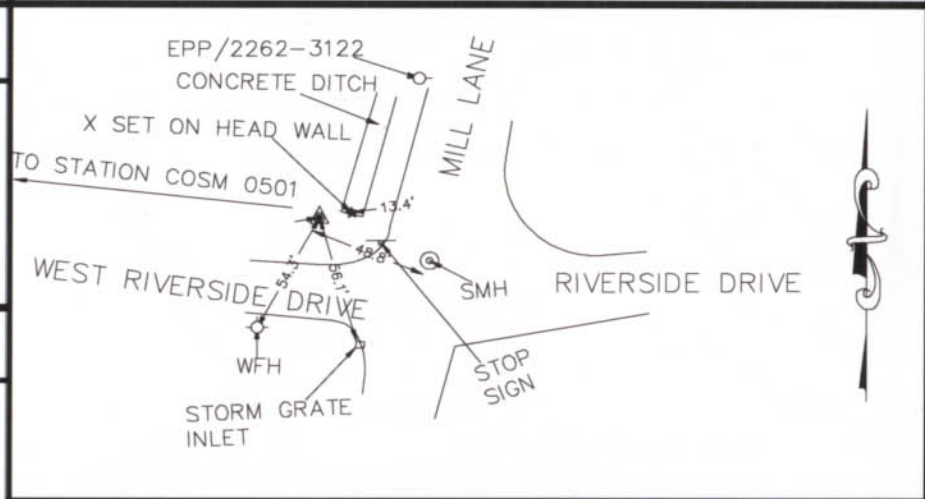

Station is located on the North West corner of the intersection of Mill Lane and West Riverside Drive

**Location**

Latitude: 37°17'05.81791"N  
Longitude: 80°04'56.53565"W

**Virginia State Plane Grid-South Zone  
NAD 83 (Based on Existing Control)**

<u>US Survey Feet</u>	<u>Meters</u>	<u>Order</u>
N: 3,631,164.2125	N: 1,106,781.0655	2nd
E: 11,022,589.3011	E: 3,359,691.9383	
<u>NAVD 88 Feet</u>	<u>NAVD 88 Meters</u>	<u>Order</u>
Elev: 1,023.30	Elev: 311.901	2nd
<u>NGVD 29 Feet</u>	<u>NGVD 29 Meters</u>	
Elev: 1,023.86	Elev: 312.074	

**Photo of Station**



**Metadata**      **Reference Station**

Convergence: -0°57'37"	Station: COSM 0501
Grid Scale Factor: 0.99994643	Grid Bearing: N81°47'02"W
Elev. Scale Factor: 0.99995621	Grid Distance: 329.94' Feet
Com. Scale Factor: 0.99990265	
Projection: Lambert	
Year Set: 2006	