

Description **Station: COSM 0501**

Station is a 4" bronze disk set in a concrete monument.

To reach the station from the intersection of Mill Lane and West Riverside Drive, proceed west on West Riverside Drive 360 +/- feet. The station is on the right in the grass, 11.9' behind electric power pole # 2226-3119.

Location

Latitude: 37°17'06.22991"N
Longitude: 80°05'00.58572"W

Virginia State Plane Grid-South Zone
NAD 83 (Based on Existing Control)

<u>US Survey Feet</u>		<u>Meters</u>		<u>Order</u>
N:	3,631,211.3626	N:	1,106,795.4369	2nd
E:	11,022,262.7519	E:	3,359,592.4060	
<u>NAVD 88 Feet</u>		<u>NAVD 88 Meters</u>		<u>Order</u>
Elev:	1,024.84	Elev:	312.371	2nd
<u>NGVD 29 Feet</u>		<u>NGVD 29 Meters</u>		
Elev:	1,025.40	Elev:	312.544	

Metadata	Reference Station
Convergence: -0°57'40"	Station: COSM 0502
Grid Scale Factor: 0.99994643	Grid Bearing: S81°47'02"E
Elev. Scale Factor: 0.99995614	Grid Distance: 329.94' Feet
Com. Scale Factor: 0.99990257	
Projection: Lambert	
Year Set: 2006	

Location Sketch

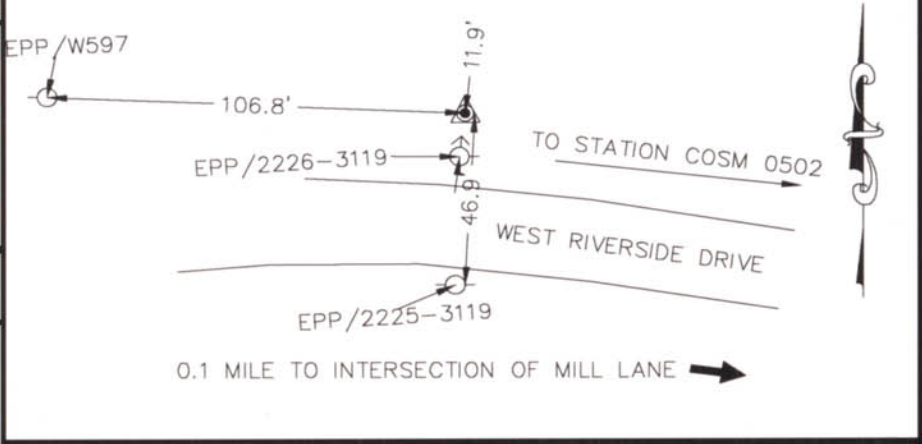

Photo of Station

