

GPS DATA SHEET

STATION DATA

STATION NAME COSM 00-19		MUNICIPALITY CITY OF SALEM	
ZONE: Virginia South	CONVERGANCE: -0°56'49.324"	YEAR SET: 2000	
PROJECTION: Lambert	COMBINED FACTOR: 0.999896975	YEAR RECOVERED: 2001	
HORIZONTAL DATA	DATUM: NAD 83/93	SCALE FACTOR: 0.999946680	ORDER: 1 st
	NORTHING: 3,627,671.0218	EASTING: 11,028,929.6049	
	LATITUDE: 37°16'32.32730"N	LONGITUDE: 80°03'37.37455"W	
VERTICAL DATA	ELEVATION FACTOR: 0.999950292		ORDER: 2 nd
	NGVD 29 ELEVATION: 1145.24 ft.		
	NAVD 88 ELEVATION: 1144.64 ft.		

REFERENCE STATION

STATION	GRID DISTANCE	GRID AZIMUTH
COSM 00-20	1351.13 ft.	288°22'00"

STATION LOCATION & DESCRIPTION

The Station is located in the southwest side of the City of Salem, Virginia.
 To reach from the Farmer's Market at the intersection of Main Street and North Broad Street, go east on East Main Street 0.1 miles to the intersection with Colorado Street. Go south on Colorado Street 1.1 miles to the intersection with Kimball Avenue. Go west on Kimball Avenue 0.2 miles to the Station on the left situated in the front yard of house #410 and across the street from the parking lot for Mount Regis Center.

The station is a brass disk set in concrete flush with the ground and stamped CITY OF SALEM SURVEY MONUMENT 00-19.

STATION SKETCH

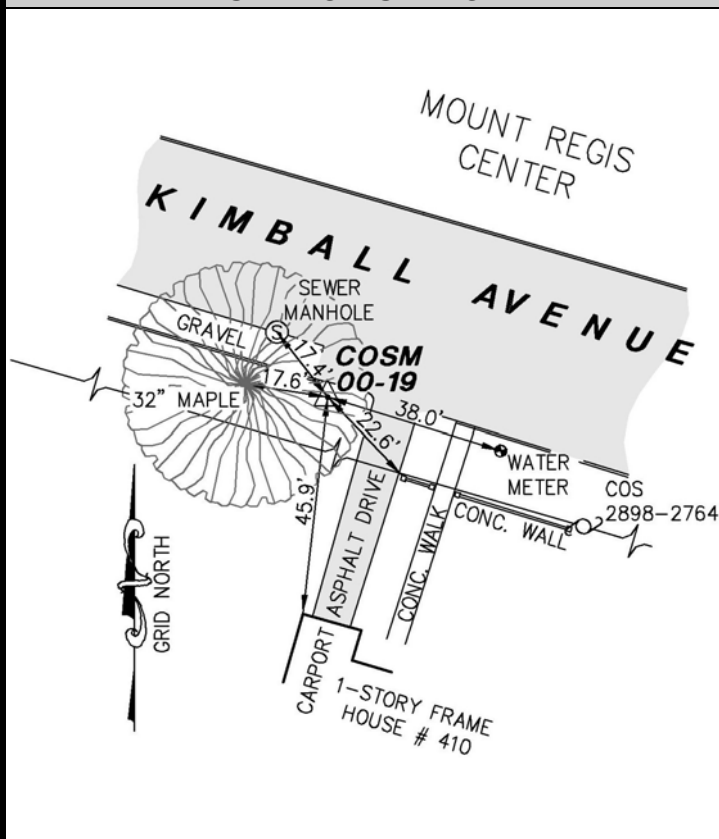

STATION PHOTOGRAPH



LUMSDEN ASSOCIATES,
ENGINEERS-SURVEYORS-PLANNERS

4664 Brambleton Avenue, SW
P.O. Box 20669
Roanoke, VA 24018

Phone: (540) 774-4411
Fax: (540) 772-9445
E-Mail: mail@lumsdenpc.com