

# GPS DATA SHEET

## Station Data

Station Name: <b>COSM 92-41</b>		Municipality: <b>City of Salem</b>	
Zone: <b>Virginia South</b>	Convergence: <b>-0° 56' 35.497"</b>	Year Set: <b>1992</b>	
Projection: <b>Lambert</b>	Combined Factor: <b>0.999887996</b>	Year Recovered: <b>2008</b>	
<b>Horizontal Data</b>	Datum: <b>NAD 83</b>	Scale Factor: <b>0.999945828</b>	Order: <b>2nd</b>
	Northing: <b>3641755.343</b>		Easting: <b>11031003.002</b>
	Latitude: <b>37° 18' 51.90460"N</b>		Longitude: <b>80° 03' 14.59274"W</b>
<b>Vertical Data</b>	Elevation Factor: <b>0.999942164</b>	Order: <b>3rd</b>	
	Elevation: (NGVD 29) <b>1209.26</b>	Elevation: (NAVD 88) <b>1208.68</b>	

## Reference Station

Station	Grid Distance	Grid Azimuth

## Station Location & Description

Point is a brass disk set in concrete (City of Salem Monument). Point is in a grass median 4' ± west of the centerline of said median. Point is 45' ± south of the nose of said median. Said point is 158'± south of the centerline of the north bound lane of intersection Interstate #81, and 1.3 miles north of the intersection of Route #311 and Route #11.

Monument was set in 1992 by TPP&S and recovered in 2008 by Caldwell White Associates.  
Chain ties have been verified and witness card updated.  
This survey data prepared using 1 meter= 3.280833 feet.

### Station Sketch

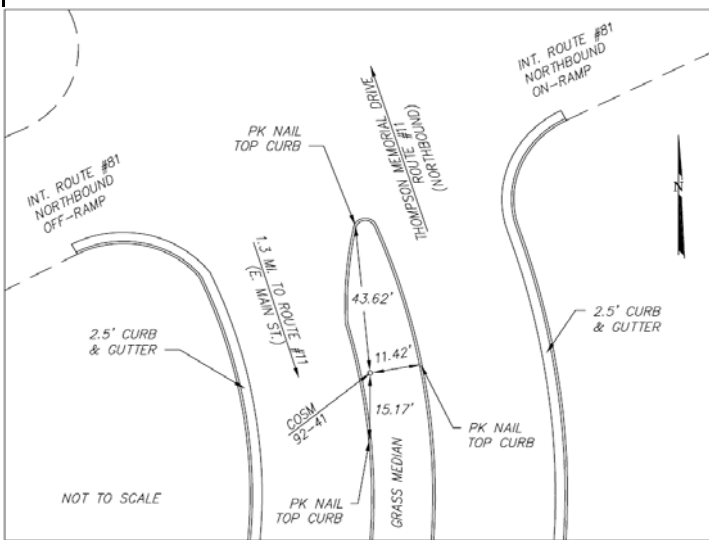

### Station Photograph



**CALDWELL WHITE ASSOCIATES**  
ENGINEERS / SURVEYORS / PLANNERS

4203 Melrose Avenue, NW  
P.O. Box 6260  
Roanoke, VA 24017

Phone: (540) 366-3400  
Fax: (540) 366-8702  
E-Mail: [cwaroanoke@aol.com](mailto:cwaroanoke@aol.com)