

GPS DATA SHEET

Station Data

Station Name: COSM 92-34		Municipality: City of Salem	
Zone: Virginia South	Convergence: -0° 56' 33.259"	Year Set: 1992	
Projection: Lambert	Combined Factor: 0.999896812	Year Recovered: 2008	
Horizontal Data	Datum: NAD 83	Scale Factor: 0.999946555	Order: 2nd
	Northing: 3629304.184	Easting: 11031096.101	
	Latitude: 37° 16' 48.82618"N	Longitude: 80° 03' 10.90483"W	
Vertical Data	Elevation Factor: 0.999950254	Order: 3rd	
	Elevation: (NGVD 29) 1040.08	Elevation: (NAVD 88) 1039.49	

Reference Station

Station	Grid Distance	Grid Azimuth

Station Location & Description

Point is a brass disk set in a concrete sidewalk (City of Salem Monument). Point is located in the centerline ± of sidewalk on the west side of the Colorado Street bridge over Norfolk-Southern tracks. Said point is 60.61' south of the northern edge of bridge. Said point is 0.1 mile south of the intersection of Colorado Street and 8th Street and 0.1 mile north of the intersection of Colorado Street and Rowan Street.

Monument was set in 1992 by TPP&S and recovered in 2008 by Caldwell White Associates.
Chain ties have been verified and witness card updated.
This survey data prepared using 1 meter= 3.280833 feet.

Station Sketch

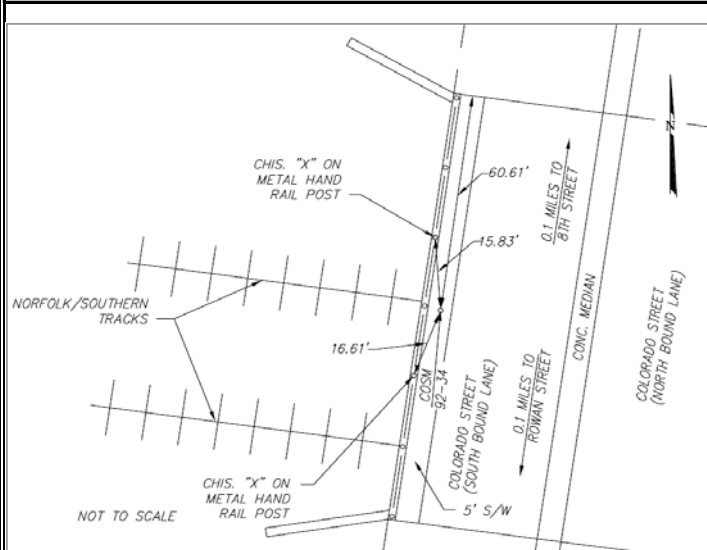

Station Photograph



CALDWELL WHITE ASSOCIATES
ENGINEERS / SURVEYORS / PLANNERS

4203 Melrose Avenue, NW Phone: (540) 366-3400
P.O. Box 6260 Fax: (540) 366-8702
Roanoke, VA 24017 E-Mail: cwaroanoke@aol.com