

# GPS DATA SHEET

## Station Data

Station Name: <b>COSM 92-31 RESET</b>		Municipality: <b>City of Salem</b>	
Zone: <b>Virginia South</b>	Convergence: <b>0° 56' 50.56421"</b>	Year Set: <b>2010</b>	
Projection: <b>Lambert</b>	Combined Factor: <b>0.999901096</b>	Year Recovered: <b>2010</b>	
<b>Horizontal Data</b>	Datum: <b>NAD83</b>	Scale Factor: <b>0.999946261</b>	Order: <b>2nd</b>
	Northing: <b>3633695.768</b>	Easting: <b>11028864.081</b>	
	Latitude: <b>37°17' 31.87797"</b>	Longitude: <b>80° 03' 39.41766"</b>	
<b>Vertical Data</b>	Elevation Factor: <b>0.999949725</b>	Order: <b>3rd</b>	
	Elevation : (NGVD 29) <b>1050.70'</b>	Elevation: (NAVD 88) <b>1050.11'</b>	

## Reference Station

Station	Grid Distance	Grid Azimuth
<b>COSM 92-30</b>	<b>668.37'</b>	<b>N 73° 44' 48"</b>

## Station Location & Description

Point is a brass disk set in a concrete sidewalk (City of Salem Monument). Point is set in the centerline ± of sidewalk at the southwest corner of the intersection of West Main Street and Union Street. Said point is 28' ± south of centerline of West Main Street and 36' ± west of the centerline of Union Street. The monument has been reset from both the original COSM 92-31 and the first COSM 92-31 RESET. Both were destroyed by sidewalk construction. Monument was set by Parker Design Group in 2010. Chain ties haven been verified and witness card updated. This survey data prepared using 1 meter = 3.280833 feet.

### Station Sketch

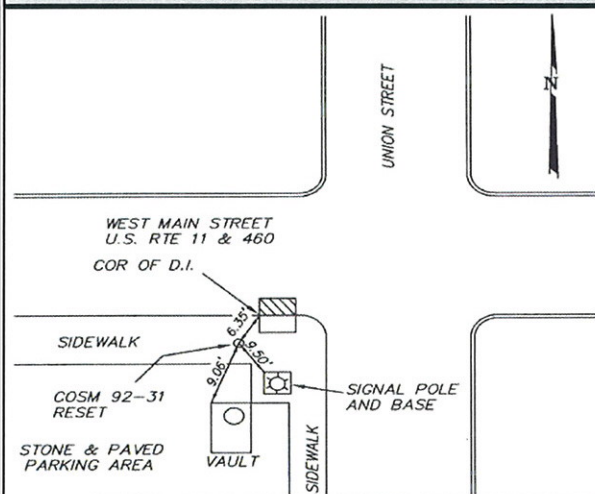

### Station Photograph



Salem Office:	816 Boulevard, Salem, Virginia 24153 P: 540-387-1153 F: 540-389-5767
Richmond Office:	1127A W. Main Street, Richmond, Virginia 23220 P: 804-358-2947 F: 804-359-9645

[www.parkerdg.com](http://www.parkerdg.com)