

# GPS DATA SHEET

## Station Data

Station Name: <b>COSM 92-24 RESET</b>		Municipality: <b>City of Salem</b>	
Zone: <b>Virginia South</b>	Convergence: <b>-0° 58' 04.310"</b>	Year Set: <b>1995</b>	
Projection: <b>Lambert</b>	Combined Factor: <b>0.999896639</b>	Year Recovered: <b>2008</b>	
<b>Horizontal Data</b>	Datum: <b>NAD 83</b>	Scale Factor: <b>0.999946361180</b>	Order: <b>2nd</b>
	Northing: <b>3632303.2186</b>	Easting: <b>11019020.8355</b>	
	Latitude: <b>37° 17' 16.484524"N</b>	Longitude: <b>80° 05' 40.92501"W</b>	
<b>Vertical Data</b>	Elevation Factor: <b>0.999950275</b>	Order: <b>3rd</b>	
	Elevation: (NGVD 29) <b>1039.56</b>	Elevation: (NAVD 88) <b>1039.00</b>	

## Reference Station

Station	Grid Distance	Grid Azimuth
<b>COSM 92-44</b>	<b>1840.95'</b>	<b>N 85° 01' 09" E</b>
<b>COSM 92-22</b>	<b>2797.97'</b>	<b>N 16° 17' 08" W</b>

## Station Location & Description

Point is a brass disk set in a concrete sidewalk (City of Salem Monument). Point is 4' ± from back of curb at the northeast corner of the intersection of Wildwood Road and Route #11/ #460. Said point is 83' ± north of the centerline of Route #11/ #460, and 46' ± east of the centerline of Wildwood Road. This monument has been reset from original COSM 92-24. COSM 92-24 was destroyed.

Monument was set in 1995 by TPP&S and recovered in 2008 by Caldwell White Associates.  
Chain ties have been verified and witness card updated.  
This survey data prepared using 1 meter= 3.280833 feet.

### Station Sketch

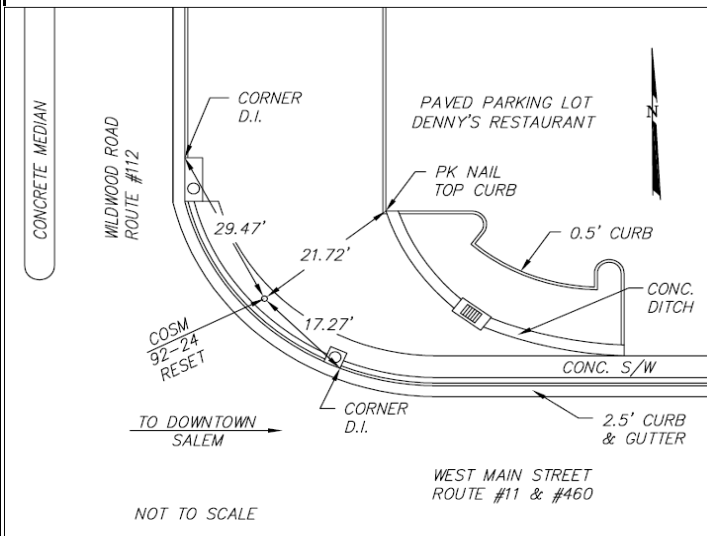

### Station Photograph



**CALDWELL WHITE ASSOCIATES**

ENGINEERS / SURVEYORS / PLANNERS

4203 Melrose Avenue, NW Phone: (540) 366-3400  
P.O. Box 6260 Fax: (540) 366-8702  
Roanoke, VA 24017 E-Mail: cwaroanoke@aol.com