

# GPS DATA SHEET

## Station Data

Station Name: <b>COSM 92-15</b>		Municipality: <b>City of Salem</b>	
Zone: <b>Virginia South</b>	Convergence: <b>-0° 55' 42.216"</b>	Year Set: <b>1992</b>	
Projection: <b>Lambert</b>	Combined Factor: <b>0.999899268</b>	Year Recovered: <b>2008</b>	
<b>Horizontal Data</b>	Datum: <b>NAD 83</b>	Scale Factor: <b>0.999946662</b>	Order: <b>2nd</b>
	Northing: <b>3627754.856</b>		Easting: <b>11037868.599</b>
	Latitude: <b>37° 16' 34.60255"N</b>		Longitude: <b>80° 01' 46.80495"W</b>
<b>Vertical Data</b>	Elevation Factor: <b>0.999952603</b>	Order: <b>3rd</b>	
	Elevation: (NGVD 29) <b>991.00</b>	Elevation: (NAVD 88) <b>990.39</b>	

## Reference Station

Station	Grid Distance	Grid Azimuth

## Station Location & Description

Point is a brass disk set in concrete (City of Salem Monument). Point is on the south side of Roanoke Boulevard 13.5' south of its southern edge of pavement. Said point is 0.3 miles east of the intersection of Roanoke Boulevard and Route #419. Point is 165' ± east of the centerline intersection with Easton Road. Said point is also 87.5' west of the southwest corner of the Roanoke Boulevard Bridge over Mason Creek.

Monument was set in 1992 by TPP&S and recovered in 2008 by Caldwell White Associates.  
Chain ties have been verified and witness card updated.  
This survey data prepared using 1 meter= 3.280833 feet.

### Station Sketch

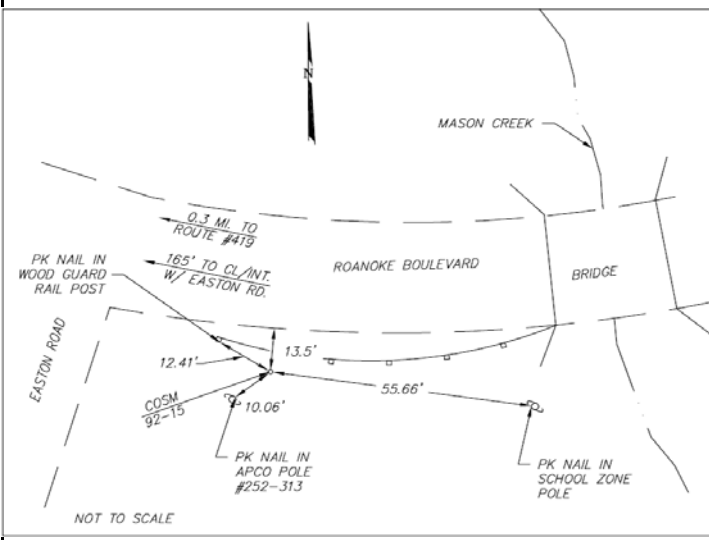

### Station Photograph



CWA

CALDWELL WHITE ASSOCIATES

ENGINEERS / SURVEYORS / PLANNERS

4203 Melrose Avenue, NW  
P.O. Box 6260  
Roanoke, VA 24017

Phone: (540) 366-3400  
Fax: (540) 366-8702  
E-Mail: cwaroanoke@aol.com