

# GPS DATA SHEET

## Station Data

|                                 |                                      |                                     |                                      |
|---------------------------------|--------------------------------------|-------------------------------------|--------------------------------------|
| Station Name: <b>COSM 92-09</b> |                                      | Municipality: <b>City of Salem</b>  |                                      |
| Zone: <b>Virginia South</b>     | Convergence: <b>-0° 55' 28.664"</b>  | Year Set: <b>1992</b>               |                                      |
| Projection: <b>Lambert</b>      | Combined Factor: <b>0.999894637</b>  | Year Recovered: <b>2008</b>         |                                      |
| <b>Horizontal Data</b>          | Datum: <b>NAD 83</b>                 | Scale Factor: <b>0.999946109</b>    | Order: <b>2nd</b>                    |
|                                 | Northing: <b>3636060.517</b>         |                                     | Easting: <b>11039807.619</b>         |
|                                 | Latitude: <b>37° 17' 57.02376"N</b>  |                                     | Longitude: <b>80° 01' 24.47499"W</b> |
| <b>Vertical Data</b>            | Elevation Factor: <b>0.999948525</b> | Order: <b>3rd</b>                   |                                      |
|                                 | Elevation: (NGVD 29) <b>1076.31</b>  | Elevation: (NAVD 88) <b>1075.69</b> |                                      |

## Reference Station

| Station | Grid Distance | Grid Azimuth |
|---------|---------------|--------------|
|         |               |              |

## Station Location & Description

Point is a brass disk set in concrete (City of Salem Monument). Point is located in a utility strip in front of National Business College. Said point is 2' north of the back of curb on the west bound lane of East Main Street and 0.2 mi. east of the intersection of East Main Street and Route #419. Said point is also 40' ± north of the centerline of East Main Street.

Monument was set in 1992 by TPP&S and recovered in 2008 by Caldwell White Associates.  
Chain ties have been verified and witness card updated.  
This survey data prepared using 1 meter= 3.280833 feet.

### Station Sketch

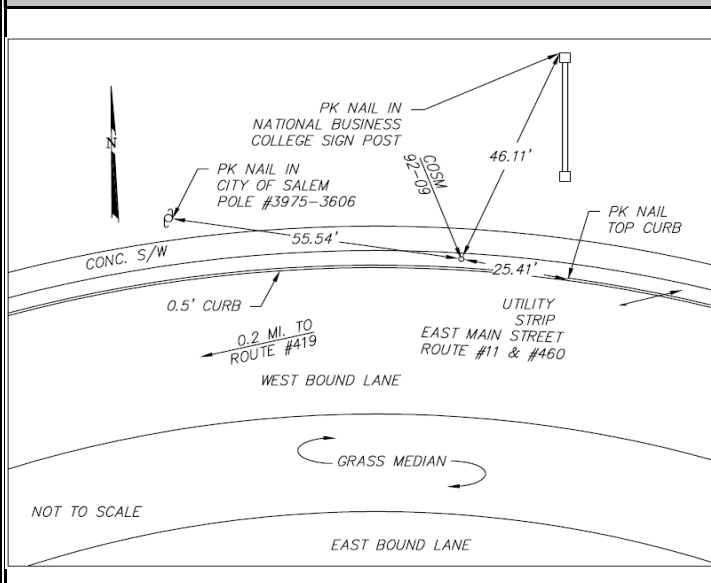

### Station Photograph



**CALDWELL WHITE ASSOCIATES**  
ENGINEERS / SURVEYORS / PLANNERS

|                         |                            |
|-------------------------|----------------------------|
| 4203 Melrose Avenue, NW | Phone: (540) 366-3400      |
| P.O. Box 6260           | Fax: (540) 366-8702        |
| Roanoke, VA 24017       | E-Mail: cwaroanoke@aol.com |