

GPS DATA SHEET

Station Data

Station Name: COSM 92-05		Municipality: City of Salem	
Zone: Virginia South	Convergence: -0° 55' 39.083"	Year Set: 1992	
Projection: Lambert	Combined Factor: 0.999892870	Year Recovered: 2008	
Horizontal Data	Datum: NAD 83	Scale Factor: 0.999945903	Order: 2nd
	Northing: 3640001.231	Easting: 11038484.199	
	Latitude: 37° 18' 35.77076"N	Longitude: 80° 01' 41.64196"W	
Vertical Data	Elevation Factor: 0.999946964	Order: 3rd	
	Elevation: (NGVD 29) 1108.96	Elevation: (NAVD 88) 1108.35	

Reference Station

Station	Grid Distance	Grid Azimuth

Station Location & Description

Point is a brass disk set in a concrete median (City of Salem Monument). Point is in the centerline ± of a concrete median 68.77' north of the nose of said median. Point is 120' ± north of the intersection of Dalewood Road and Route #419, and said point is 0.8 miles north of the intersection of Route #419 and Route #11 (East Main Street).

Monument was set in 1992 by TPP&S and recovered in 2008 by Caldwell White Associates.
Chain ties have been verified and witness card updated.
This survey data prepared using 1 meter= 3.280833 feet.

Station Sketch

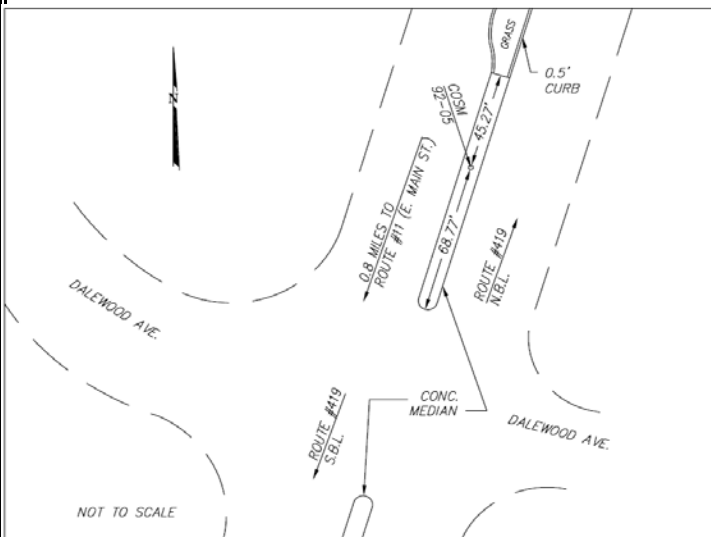

Station Photograph



CALDWELL WHITE ASSOCIATES
ENGINEERS / SURVEYORS / PLANNERS

4203 Melrose Avenue, NW Phone: (540) 366-3400
P.O. Box 6260 Fax: (540) 366-8702
Roanoke, VA 24017 E-Mail: cwaroanoke@aol.com