

CURVE	DATA
Curve Lot #	Delta
A 3 3	12°06'54"
A 4 3	12°32'50"
A 5 3	6°56'30"
A TOTAL	31°36'14"
B 15 2	19°11'38"
B 16 2	12°24'36"
B TOTAL	31°36'14"
C 2 3	94°51'30"
D 12 2	85°08'30"
E 12 2	6°14'30"
F 9 3	8°55'56"
F 10 3	10°15'18"
F TOT	19°11'14"
G 6	17°45'50"

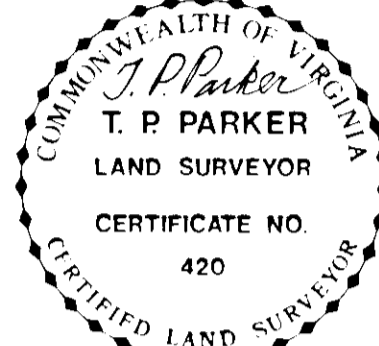

LEGEND
 M.B.L. MINIMUM BUILDING LINE
 T.E. TELEPHONE & ELECTRIC
 D.E. DRAINAGE EASEMENT

NOTE: TRACT "A" RETAINED BY OWNER AND IS NOT A SEPARATE BUILDING LOT. SEGMENT OF 40' RADIUS TEMPORARY TURNAROUND SHALL REVERT TO ADJOINING OWNERS WHEN STREET IS EXTENDED.

KNOW ALL MEN BY THESE PRESENTS TO WIT:
 THAT WESTCLUB CORPORATION IS THE OWNER OF THE TRACT OF LAND SHOWN HEREON, BOUNDED BY CORNERS 1 THRU 21, INCLUSIVE, CONTAINING 6.613 AC AND KNOWN AS SECTION 2, WOODBRIDGE, WHICH SAID LAND IS THE REMAINING PORTION OF THE PROPERTY CONVEYED TO SAID OWNER BY DEED DATED JUNE 26, 1972 FROM G.L. & RUBY M. MATTERN, RECORDED IN D.B. 22, PG. 696 IN THE CLERK'S OFFICE OF THE CIRCUIT COURT OF SALEM, VIRGINIA.
 THE SAID OWNER HEREBY DEDICATES TO THE CITY OF SALEM, VA., IN FEE SIMPLE AND ALSO TO THE COUNTY OF ROANOKE IN FEE SIMPLE THE STREETS AS SHOWN HEREON LYING WITHIN EACH JURISDICTION AND FURTHER DEDICATES TO THE CITY OF SALEM AND THE COUNTY OF ROANOKE CERTAIN EASEMENTS FOR PUBLIC UTILITIES AND DRAINAGE PURPOSES AS SHOWN HEREON. THE SAID OWNER FURTHER CERTIFIES THAT IT HAS SUBDIVIDED THIS LAND AS SHOWN HEREON ENTIRELY WITH ITS OWN FREE WILL AND ACCORD PURSUANT TO AND IN COMPLIANCE WITH SECTIONS 151-477 OF THE 1950 CODE OF VIRGINIA AS AMENDED TO DATE AND FURTHER PURSUANT TO AND IN COMPLIANCE WITH TITLE 15, CHAPTER 2 (LAND SUBDIVISION REGULATIONS) AS AMENDED TO DATE OF THE GENERAL ORDINANCES OF THE CITY OF SALEM, VIRGINIA, AND FURTHER PURSUANT TO AND IN COMPLIANCE WITH THE SUBDIVISION ORDINANCE OF ROANOKE COUNTY, VA. THE SAID OWNER DOES AS A CONDITION PRECEDENT TO THE APPROVAL OF THIS PLAT BY THE COUNCIL AND PLANNING COMMISSION OF THE CITY OF SALEM, VA, AND THE BOARD OF SUPERVISORS OF ROANOKE COUNTY, VA HEREBY RELEASE SAID CITY OF SALEM, VA AND ROANOKE COUNTY, VA, AND THE VIRGINIA DEPT. OF HIGHWAYS FROM ANY CLAIM OR CLAIMS OR DAMAGES WHICH SAID OWNER, ITS SUCCESSORS AND ASSIGNS MAY HAVE OR ACQUIRE AGAINST SAID CITY OF SALEM, VA, COUNTY OF ROANOKE, VA, AND THE VA. DEPT. OF HIGHWAYS BY REASON OF ESTABLISHING PROPER GRADE LINES ON AND ALONG THE STREETS SHOWN HEREON AND BY REASON OF DOING THE NECESSARY GRADING, CUTTING OR FILLING FOR THE PURPOSE OF PLACING SUCH STREETS UPON THE PROPER GRADE AS MAY FROM TIME TO TIME BE ESTABLISHED BY SAID CITY OF SALEM, VA., COUNTY OF ROANOKE AND VIRGINIA DEPT. OF HIGHWAYS AND SAID CITY, COUNTY AND VIRGINIA DEPT. OF HIGHWAYS SHALL NOT BE REQUIRED TO CONSTRUCT ANY RETAINING WALL OR WALLS ALONG THE STREETS AND PROPERTY LINES THEREOF.
 WITNESS THE FOLLOWING SIGNATURES AND SEALS ON THIS 9th DAY OF March, 1977.

APPROVED:
Randolph M. Smith
 EXEC. SECY. CITY OF SALEM PLANN. COMM. 3/14/77
William Taylor
 SALEM CITY ENGINEER 3/14/77
[Signature]
 EXEC. SECY. OF ROANOKE COUNTY PLANNING COMMISSION 3/11/77
 I HEREBY CERTIFY THAT THIS PLAT OF SURVEY IS CORRECT
J. P. Parker
 STATE CERTIFIED LAND SURVEYOR

BOUNDARY DATA		NORTH	SOUTH	EAST	WEST
1-2	S 39°18'30"E	150.0	116.02	95.02	
2-3	S 46°03'10"W	211.26	146.61		152.10
3-4	S 38°16'30"N	114.79	90.12		71.11
4-5	N 70°54'44"W	42.58	13.92		40.24
5-6	S 19°05'16"W	37.29	82.49		28.55
6-7	S 27°58'11"W	182.01	160.75		85.36
7-8	N 68°02'W	94.53	72.56		180.49
8-9	N 15°10'E	188.71	182.14		41.37
9-10	N 17°34'E	280.50	267.42		84.66
10-11	N 25°54'E	106.32	95.64		46.44
11-12	N 28°40'30"E	147.60	129.50		70.82
12-13	N 35°32'30"E	148.40	120.75		86.26
13-14	N 65°20'30"E	136.30	56.87		123.87
14-15	N 42°41'30"E	65.70	48.29		44.55
15-16	N 68°51'30"E	83.51	29.98		77.94
16-17	S 33°04'E	205.22	171.98		111.97
17-18	S 53°48'45"W	90.45	53.40		73.00
18-19	S 50°41'30"W	21.96	13.91		16.99
19-20	S 50°41'30"W	100.36	63.58		77.65
20-21	S 50°41'30"W	125.57	79.55		97.16
21-1	S 39°18'30"E	50.0	38.69		31.68

BOUNDARY CONTAINS 6.597 ACRES

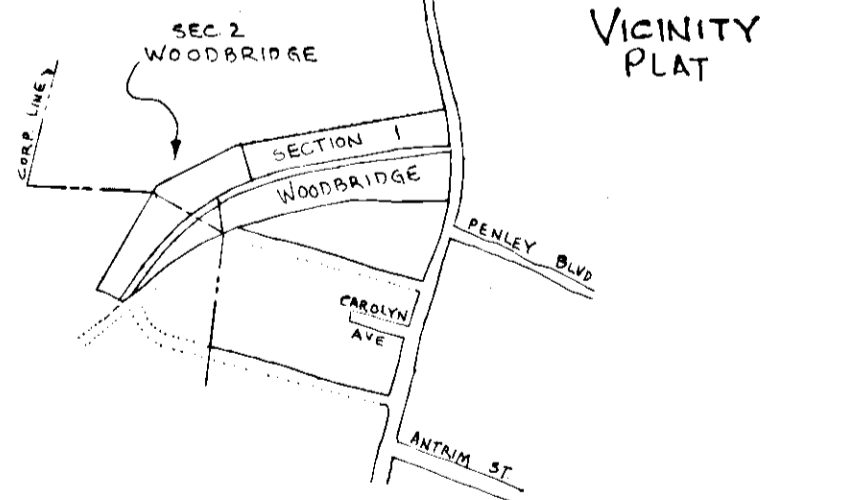

WESTCLUB CORPORATION
L.S. Waldrop
 L.S. WALDRUP, PRESIDENT
 ATTEST: *Lewis P. Thomas*
 LEWIS P. THOMAS, ASST. SECY.

STATE OF VIRGINIA TO WIT:
 COUNTY OF ROANOKE
 I, LINDA T. SMILEY, A NOTARY PUBLIC IN AND FOR THE AFORESAID STATE AND COUNTY, DO HEREBY CERTIFY THAT L.S. WALDRUP AND LEWIS P. THOMAS WHOSE NAMES ARE SIGNED TO THE FOREGOING WRITING DATED Mar 9, 1977, HAVE EACH PERSONALLY APPEARED BEFORE ME IN MY AFORESAID JURISDICTION AND ACKNOWLEDGED THE SAME ON THIS 9th DAY OF Mar, 1977.

IN THE CLERK'S OFFICE FOR THE CIRCUIT COURT OF SALEM, VA., THIS MAP WAS PRESENTED AND WITH THE CERTIFICATE OF ACKNOWLEDGMENT THERETO ANNEXED, ADMITTED TO RECORD AT ___ O'CLOCK ___ M. ON THIS ___ DAY OF ___, 1977.

TESTE: _____
 CLERK

MY COMMISSION EXPIRES: MAY 28, 1979
Linda T. Smiley
 NOTARY PUBLIC

MAP OF SECTION 2 WOODBRIDGE PROPERTY OF WESTCLUB CORPORATION

CATAWBA MAGISTERIAL DISTRICT, ROANOKE COUNTY AND CITY OF SALEM, VIRGINIA
 SCALE: 1" = 50'
 BY T. P. PARKER & SON ENGINEERS & SURVEYORS
 JUNE 25, 1976